

DRIVE MOTION LITHIUM DATA SHEET



LFP12.8V100AH (24)



Electrical Specifications

Nominal Voltage	12.8 V
Nominal Capacity	100 Ah
Energy	1280 Wh
Self Discharge	≈3% per month
Efficiency	>98%
Parallel Support	Yes, Max 2 Sets
Series Support	Yes, Max 4 Sets

Discharge Specifications

Max. Discharge Current	100 A
End of Discharge Voltage	11.2 V
Pulse Discharge Current	270 A @ 10s
Low Voltage Disconnect	10 V
Low Voltage Reconnect	11.2 V

Charge Specifications

Charging Voltage	14.6 V
Max. Charging Current	100 A
Recommended Charging Current	10 A - 50 A
High Voltage Disconnect	14.8 V
High Voltage Reconnect	13.8 V

Temperature Specifications

Discharge Temperature	-20°C - +55°C (-4°F - +131°F)
Charge Temperature	-20°C - +55°C (-4°F - +131°F)
Storage Temperature	-10°C - +45°C (14°F - +113°F)
High Temperature Disconnect	+75°C (+167°F)
High Temperature Reconnect	+70°C (+158°F)
Low Temperature Disconnect	-20°C (-4°F)
Low Temperature Reconnect	-15°C (5°F)

Dimensional Specifications

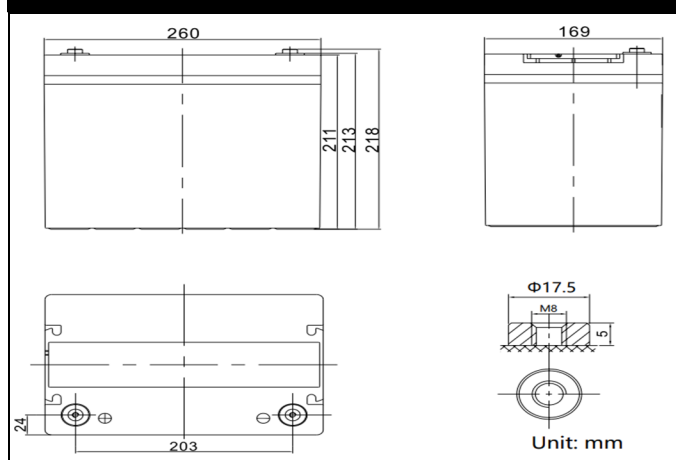

Mechanical Specifications

Dimensions (Group 24)	260 x 168 x 211 10.24 x 6.62 x 8.31
Weight	10 Kg (22 lbs)
Terminal Type	M8
Terminal Torque	9.8N/m
Enclosure Protection	IP65

Selfheating Specifications

Heating Temperature	-20°C - +10°C (-4°F - +50°F)
Activation Voltage	14.6 V
Heating Current	7 A
Heating Power	100 W

Conception & Compliance

Conception	4S2P
Cell Type	Grade A Prismatic LiFePO4 cells (50Ah)
Certifications	UN38.3 & CE (battery), UL1642 (cells)
Shipping Classification	UN 3480, CLASS 9

DRIVE MOTION LITHIUM DATA SHEET



Charge Voltage & State of Charge (SOC) 0.2C@25°C (77°F)

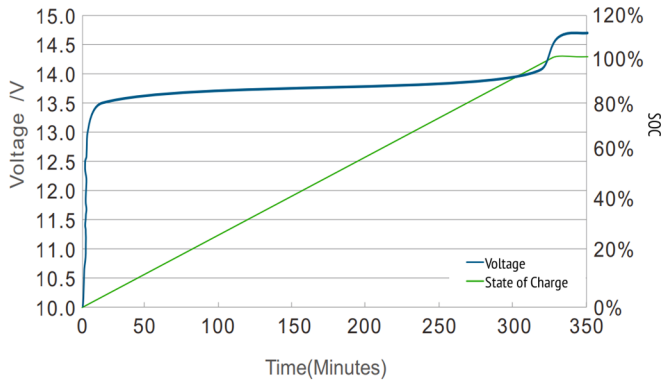

Discharge Voltage Characteristics at Various Rates 25°C (77°F)

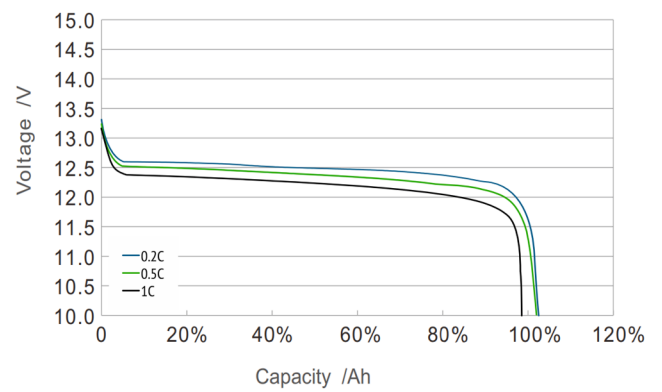

Capacity at Different Temperatures

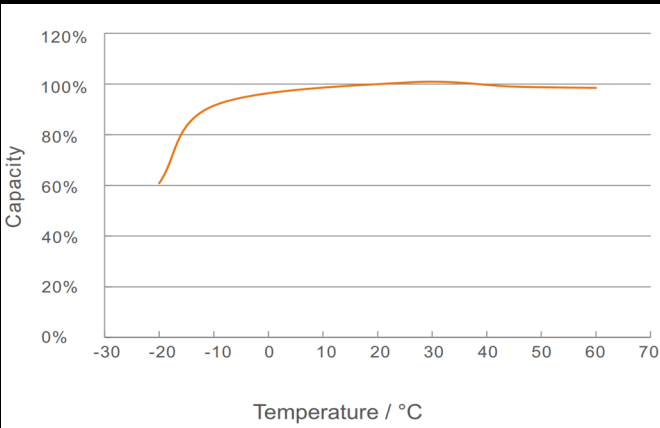

Typical Recharge Time

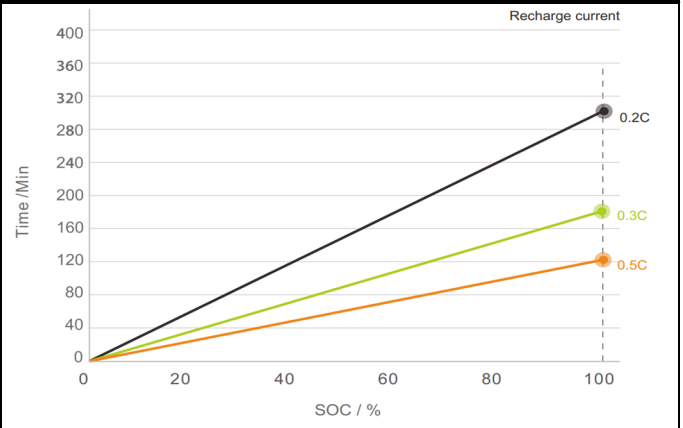

Self Discharge Curve at Different Temperatures

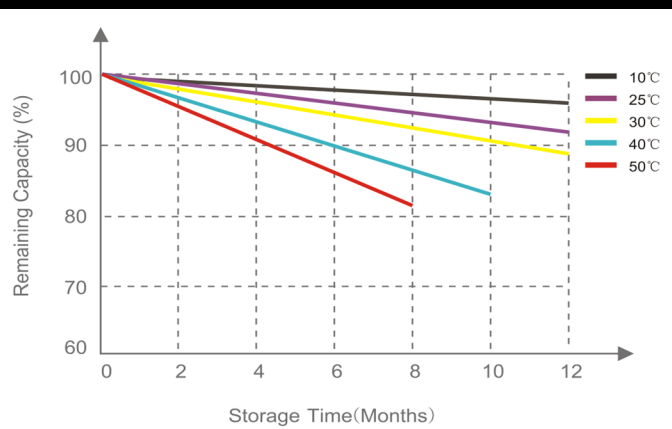

Typical Cycle Life

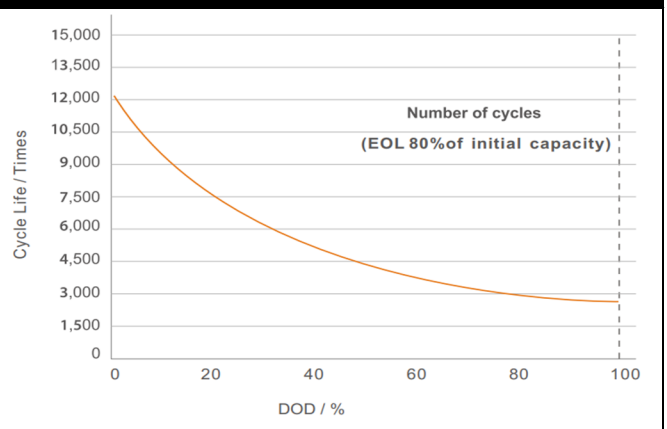

DRIVE MOTION LITHIUM DATA SHEET



Bluetooth App User Guide

Note to user: If the battery receives no charge or is not discharged for over 60 mins, the battery will enter sleep mode. To wake up the battery, simply apply a charge or load and the battery will be visible and ready for pairing in the app.

To download the app scan QR codes below or search for **Bluetooth Li** in the **App Store** or **Google Playstore**

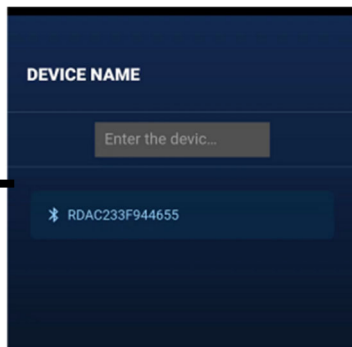

Bluetooth ID

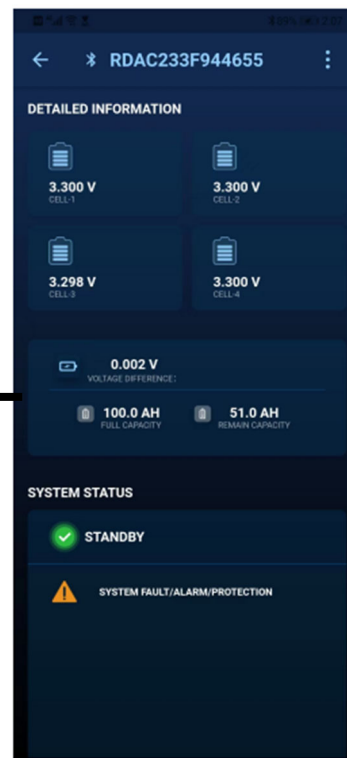

Cell Voltage

Cell Voltage Difference

Remaining Capacity

Rated Capacity

Status: Standby,
Charge or Discharge

Alarm & Protection:

- Low temp. alarm
- Low temp. protection
- High temp. alarm
- High temp. protection
- Low voltage alarm
- Low voltage protection

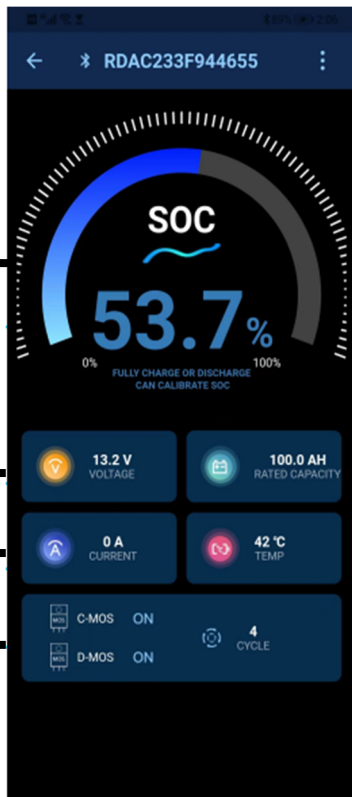

State of Charge

Battery Voltage

Battery Current

Charge & discharge
MOS control status

Rated Capacity

Battery temperature

Number of cycles